

CENSUS 2000 BLOCK MAP: ATALAYA Barrio

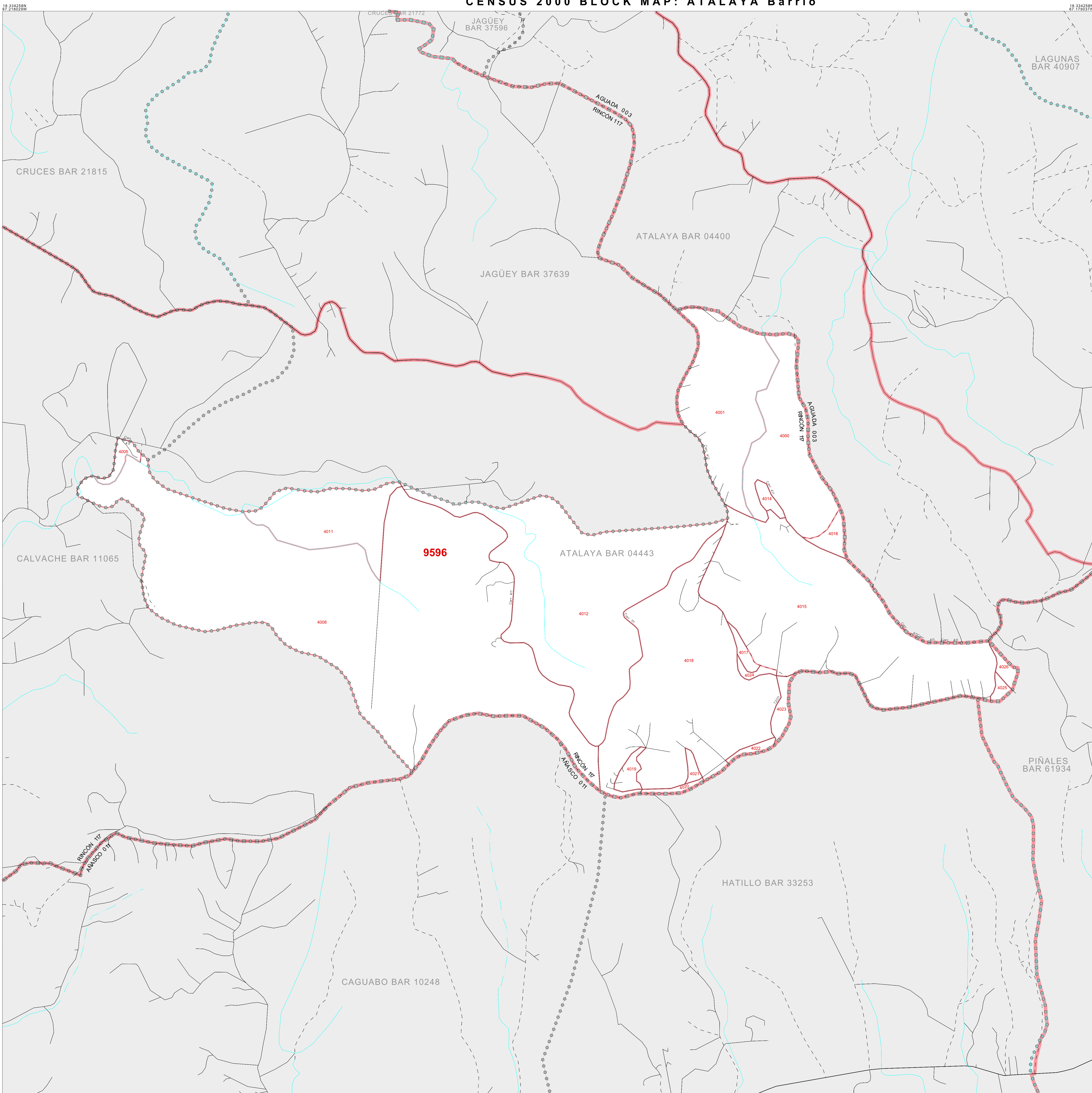

**LEGEND**

SYMBOL	NAME STYLE
*****	INTERNATIONAL
-----	PUERTO RICO
-----	MUNICIPIO
-----	BARRIO / BARRIO-PUEBLO
-----	Subbarrio
-----	Place within Subject Entity
-----	Comunidad / Zona Urbana
-----	Place outside of Subject Entity
-----	Comunidad / Zona Urbana
-----	<b>Census Tract</b>
-----	CENSUS BLOCK <sup>1</sup>

  

**FEATURES**

Highway	Pipe/Pipe Line	Stream/Shoreline
Secondary Road	Ridge/Physical Feature	Intermittent Stream
See Trail/Access/Ezra	Property/Fence Line	River / Lake
Railroad	Nonvisible Boundary	

Where international, state, and/or county boundaries coincide, the map shows the boundary symbol for only the highest-ranking of these boundaries.  
<sup>1</sup> A "\*" following a block number indicates that the block number is repeated elsewhere in the block.

Key to Adjacent Sheets

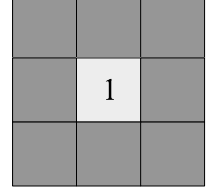

SHEET 1 OF 1 PARENT SHEET  
 TOTAL SHEETS: 1 (Index 0; Parent 1; Inset 0)

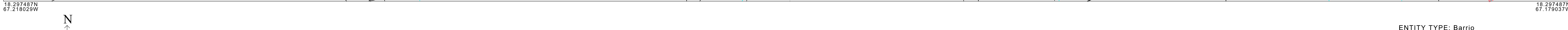

All legal boundaries and names are as of January 1, 2000. The boundaries shown on this map are for Census Bureau statistical data collection and tabulation purposes only; their depiction and designation for statistical purposes does not constitute a determination of jurisdictional authority or rights of ownership or entitlement. Source: U.S. Census Bureau's TIGER database (Census 2000). Projection: State-based Albers's Equal Area. U.S. DEPARTMENT OF COMMERCE Economics and Statistics Administration U.S. Census Bureau

ENTITY TYPE: Barrio  
 NAME: Atalaya barrio (04443)  
 ST: Puerto Rico (72)  
 CO: Rincón Municipio (117)

